

# Welcome to our kitchen design service!

We talk about design a lot, and when it comes to kitchens, design becomes an even bigger conversation. It begins with the design of each component:

- At first, we discuss the function & the form to make sure your Neptune Kitchen fits your lifestyle and needs.
- The next step in the designing process is our in-depth interior design part where we create the style and mood to achieve a coherent whole look for your home.



## How does it work?

We start to explore composition. How to bring together all the elements in a way that suits your space and your needs. It's about designing an entire room for You & Your family. Our aim is to help you create the mood you wish, get the ingredients right, make sure there is the right flow, room to prepare a meal, space to dine, drink and dance.

## Initial Kitchen Consultation

The first stage of our design process is a get-together with our design team here in our showroom in Neptune by Global Village KCR, Kimmage, where we will talk you and walk you through each of our kitchen styles in person, to help you decide which one feels like it might be the right fit. This is a complimentary service and takes about 60 minutes. You can book it over the phone, via email or by dropping in-store.

# First step

After contacting our team, you will receive our introductory email to explain and prepare you for our first meeting.

We will then invite you to meet with design team in-store or virtually, for our complimentary consultation which will take up to 1 hour to discuss your wish list and project brief.

At this meeting, we will guide you through a detailed inspection of all Neptune kitchens and an explanation of their features, benefits and materials.

Finally, we will provide you with an estimated value and initial concept design around 2 weeks later of the consultation.







## Our full design service

After your first design consultation, if you decide that you'd like to proceed, you'll experience our in-depth and expert full design service. This is the part where rough ideas and outlines become your fully-formed vision and where your kitchen really starts to come to life (keep scrolling to find out more about what's included).

There's a €3000 design commitment fee required at this stage, this commitment is deducted from the full price of your Neptune kitchen. It's also good to know that, when you place your order, we'll only ask for a 30% deposit, with the rest due 21 days before we fit your kitchen.

# Designing the kitchen you've always wanted

## What you'll get from our full design service

A home visit

Tailor-made design

Presentation of plans and visuals

A full project quotation

Interior Design Service

Specialist installation with our Lifetime

Guarantee

(all of meetings takes approximately 90 min each)

\* Full T&C attached below







## A home visit

Your designer with installation manager will come to your home and do all of the precise measuring up for you. It takes the pressure of providing accurate dimensions off you and puts it on us to get right for you.

## Tailor-made design

Everyone's vision and version of a 'perfect home' is different, each person's style, likes and dislikes are different, and that's great, as no one is alike, being you is perfection in its form. With our design service, your designer will guide you through the whole process until we get to what perfection means to you.





## Plans and visuals

You don't simply get to see an A3 plan of your kitchen, but elevations and 3D views too. It makes it so much easier for you to feel confident you're making all the right choices.

## A full project quotation

So that you can easily see exactly what costs what and where you might want to make any changes before we move to stage when we officially place your order.





## Interior Design Service

When we have all the form & the function approved by you, we move to fun part where we discuss in depth colours, materials and finishes. In this part of your project we create the mood.

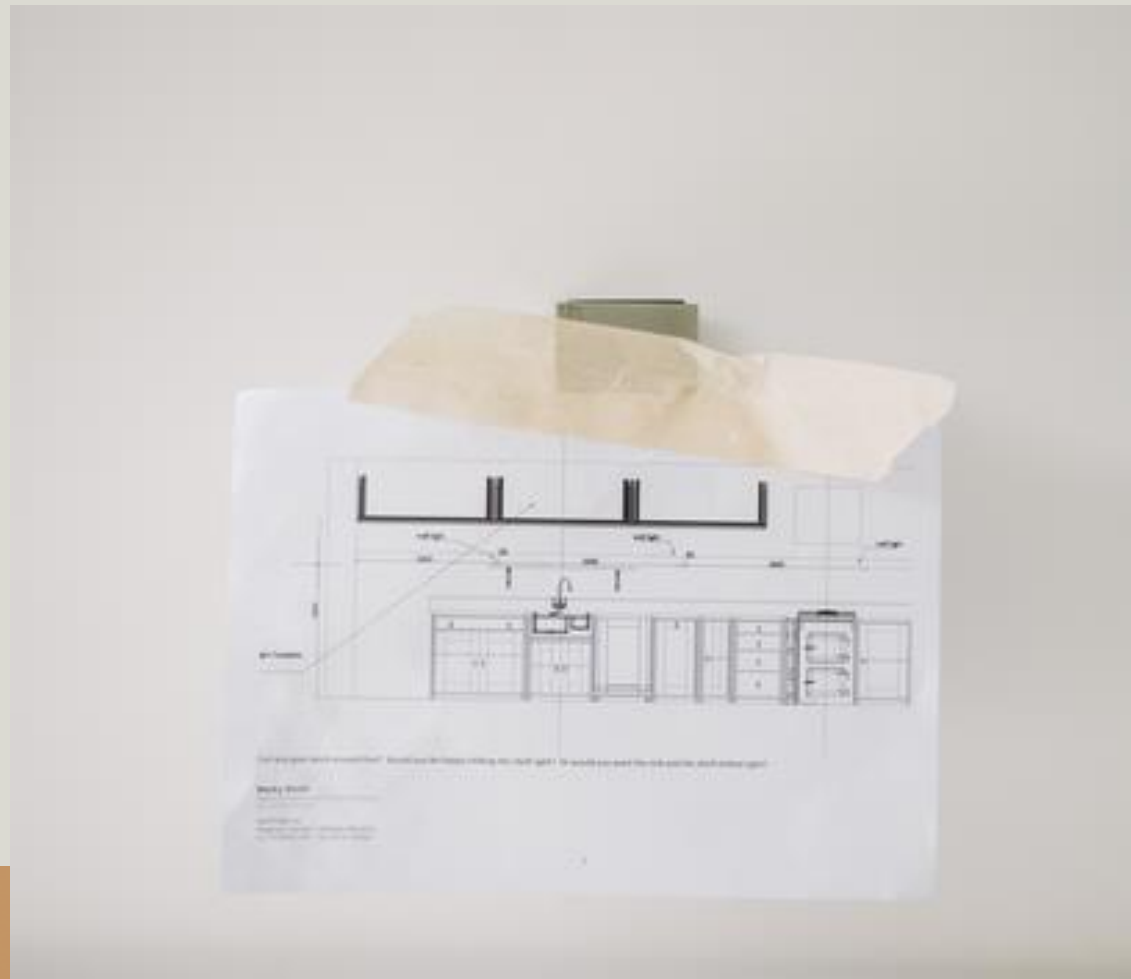

## Specialist installation with our Lifetime Guarantee

We want to look after you and your kitchen from the word go to the very end, when it's all settled in your home. All of our fitters are trained at our Wiltshire academy, so they know all there is to know about installing a Neptune kitchen. And the last you'll get is our lifetime guarantee so we can carry on taking care of you for years and years to come.

\* Full T&C attached below





# Full Kitchen Design Service Terms & Conditions

with Neptune by Global Village

1. Initial design stage – 1 hour FOC consultation followed by initial concept design presentation.

**If you decide to proceed with our design service, a €3000 commitment fee is required at this stage.**

2. Technical Survey of your home – once this is ready to take measurements.

3. Design Presentation – in-store/online – starting with concept meeting followed by 2 further set of changes, if required, until layout is approved.

**Any further changes will be charged at €90 per hour.**

4. Full set of drawings and project final quotation.

**Sign off approval required at this stage and 30% deposit required. The balance will be requested 3 weeks in advance of fitting.**

5. Interior Design Service – final finishes, colour scheme, flooring, furniture and accessories illustrated through mood boards and sample boards.

6. Technical survey with client or builder before fitting – M&E drawings for the Electrician, Plumber and Builder to be discussed on site with our installation team.

**Any additional site calls will be charged at €90/hour.**

7. Kitchen Installation – Neptune Installation Team will fit your kitchen to high standard and return after the stone worktop has been fitted (around 2-3 weeks later) for final alignments and Neptune's signature coat of paint.

8. Lifetime Guarantee – presented after your kitchen is fully installed and all remedial works finalised. Please see our T&C's for more detail.

NOTE: Commitment fee to the value of €3000 is non refundable, but will be credited to the final price agreed at approval sign off. We will require a 30% deposit, which will include your commitment fee, before we order and reserve your cabinetry and continue with the process. The balance of 70% will be requested 3 weeks before delivery of the kitchen. This can be paid over the phone or by bank transfer to the bank details attached.

# Thank you for choosing Neptune's kitchen & design service.

We hope this brochure and all of the information attached is what you are looking for, if the answer to this is yes, please contact our design team.

[design@globalvillage.ie](mailto:design@globalvillage.ie)

We'd love to hear from you!